



LEGEND

- Cadastral boundaries
- DPI Bush Forever sites
- Study Boundary

NOTES

Base cadastral, land ownership and aerial photography used on this project supplied by City of Gosnells

Aerial photography based on the ECW files generated by DOLA of the Dec 2004/Jan 2005 aerial photography.

Bush Forever details supplied by Department of Planning and Infrastructure in June 2002

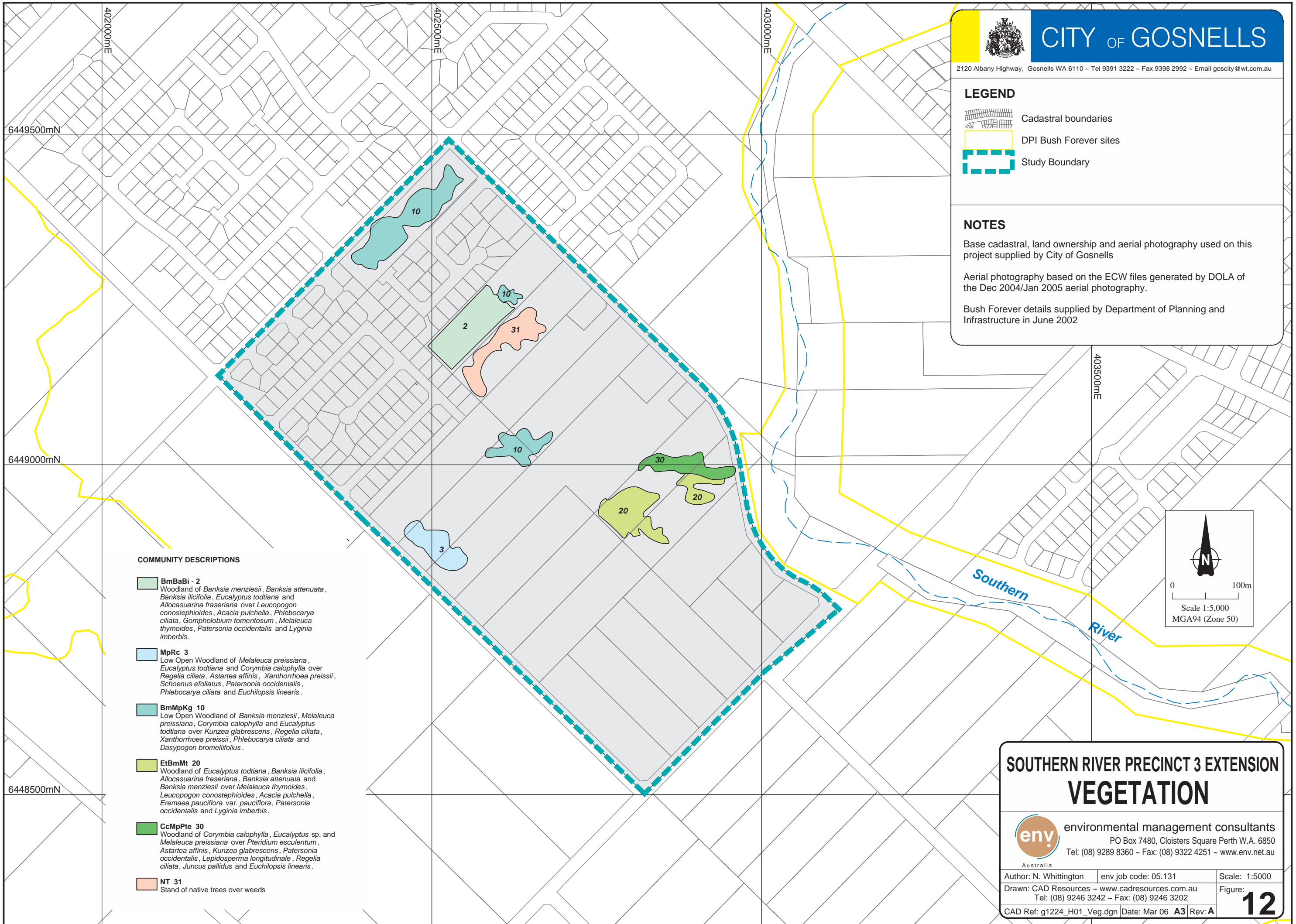

COMMUNITY DESCRIPTIONS

- BmBaBi - 2**
Woodland of *Banksia menziesii*, *Banksia attenuata*, *Banksia ilicifolia*, *Eucalyptus totiana* and *Allocasuarina fraseriana* over *Leucopogon conostephioides*, *Acacia pulchella*, *Phlebocarya ciliata*, *Gompholobium tomentosum*, *Melaleuca thymoides*, *Patersonia occidentalis* and *Lyginia imberbis*.
- MpRc 3**
Low Open Woodland of *Melaleuca preissiana*, *Eucalyptus totiana* and *Corymbia calophylla* over *Regelia ciliata*, *Astartea affinis*, *Xanthorrhoea preissii*, *Schoenus efoliatus*, *Patersonia occidentalis*, *Phlebocarya ciliata* and *Euchilopsis linearis*.
- BmMpKg 10**
Low Open Woodland of *Banksia menziesii*, *Melaleuca preissiana*, *Corymbia calophylla* and *Eucalyptus totiana* over *Kunzea glabrescens*, *Regelia ciliata*, *Xanthorrhoea preissii*, *Phlebocarya ciliata* and *Dasyopogon bromeliifolius*.
- EtBmMt 20**
Woodland of *Eucalyptus totiana*, *Banksia ilicifolia*, *Allocasuarina fraseriana*, *Banksia attenuata* and *Banksia menziesii* over *Melaleuca thymoides*, *Leucopogon conostephioides*, *Acacia pulchella*, *Eremaea pauciflora* var. *pauciflora*, *Patersonia occidentalis* and *Lyginia imberbis*.
- CcMpPte 30**
Woodland of *Corymbia calophylla*, *Eucalyptus* sp. and *Melaleuca preissiana* over *Pteridium esculentum*, *Astartea affinis*, *Kunzea glabrescens*, *Patersonia occidentalis*, *Lepidosperma longitudinale*, *Regelia ciliata*, *Juncus pallidus* and *Euchilopsis linearis*.
- NT 31**
Stand of native trees over weeds

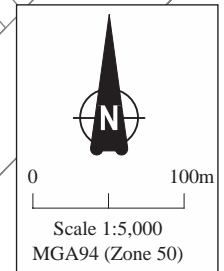

SOUTHERN RIVER PRECINCT 3 EXTENSION VEGETATION

environmental management consultants
 PO Box 7480, Cloisters Square Perth W.A. 6850
 Tel: (08) 9289 8360 - Fax: (08) 9322 4251 - www.env.net.au

Author: N. Whittington | env job code: 05.131 | Scale: 1:5000
 Drawn: CAD Resources - www.cadresources.com.au | Figure: 12
 Tel: (08) 9246 3242 - Fax: (08) 9246 3202
 CAD Ref: g1224_H01_Veg.dgn | Date: Mar 06 | A3 | Rev: A